

## 51410 BANJO STEM SINGLE DOUBLE

Материал Brass/PVC/1.0619

Налягане PN 20

Размер 1/8" - M12x1,5

### APPLICATIONS

- Pneumatic automation
- Automotive
- Textile, Packaging
- Compressed Air Circuit
- Vacuum

### VARIANTS AND ADVANTAGES

- Quick connection and disconnection
- Full Flow and Vacuum resistant tank to special shaped seals
- threads available:
  - BSPP
  - BSPT (universal short)
  - Metric
- Metal Robustness
- Wide Range
- Silicon Free

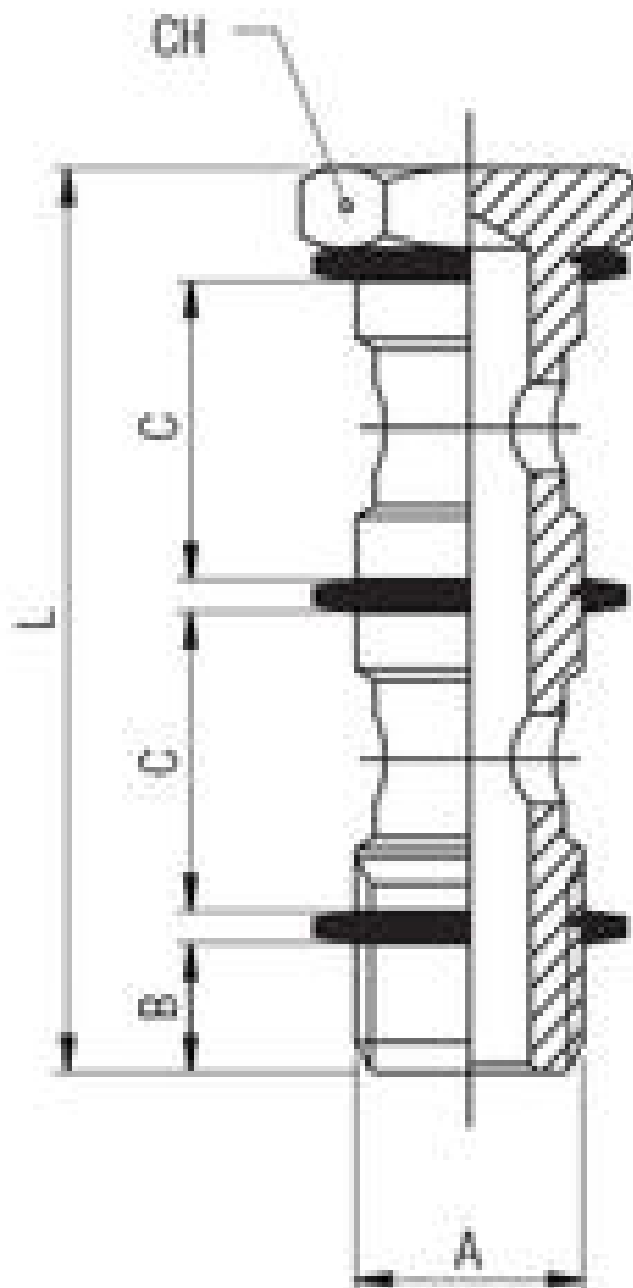

No.	Parts	Material
1	Body	Nickel-plated brass
2	Rings	Acetalic resin

# 51410 BANJO STEM SINGLE DOUBLE

Материал Brass/PVC/1.0619

Налягане PN 20

Размер 1/8" - M12x1,5

Specifications		
Standards Reference:	ROHS 2011/65/CE	
	PED 2014/68/UE	
	ISO 14743:2004	
	Silicon free	
Size:	1/8- M12x1	5"

Code	A	B	C	L	Ch	*	Bag
5142000011	1/8	6	15	44.5	14		10
5142000012	1/4	8	17	50.5	17		10
5142000013	3/8	9	20	58	19		10
5142000014	1/2	10	24	68	24		10
5142000015	M12X1,5	8	17	50.5	17	With this banjo stem using 1/4 orienting banjo body.	10