

CAST STEEL BALL VALVE WAFER • DIN PN 16

Материал steel 1.0619; DIN GS-C25

Налягане PN 16

Размер DN-65-100

APPLICATION

Corrosive fluids. Fuel oil, lubricating oil and flammable hydraulic oil. Cargo oil. Air. Gas. Non-flammable hydraulic fluid. Boiler feedwater, condensate. Seawater and freshwater.

VARIANTS

Other materials on request.

OPTIONS

Relief hole on ball

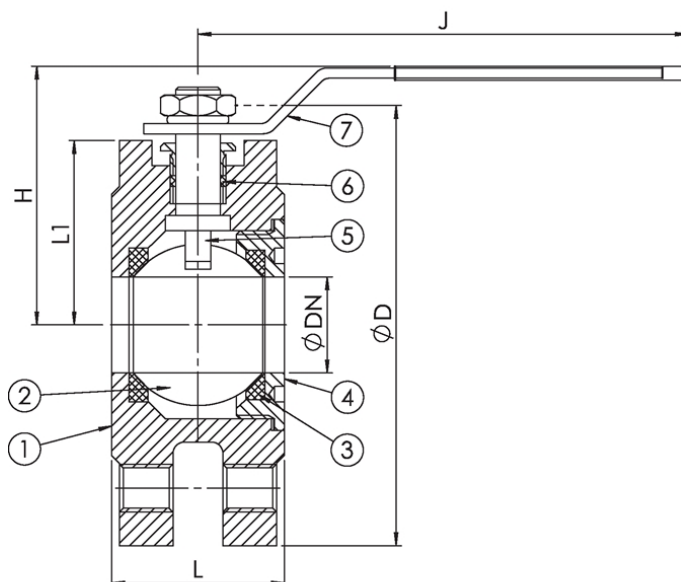

No.	Part	Material	Specifications	
1	Body	Carbon steel 1.0619; DIN GS-C25;	Standart:	DIN 33571,2 and EN 12516-1
2	Ball (relief hole)	Stainless steel 1.4408 (AISI316)	Flange standard:	EN1092-2
3	Seat	PTFE	Face to face standard:	EN558, Series 1
4	Cap	Stainless steel 1.4408 (AISI316)	Execution:	Straight
5	Stem	Stainless steel 1.4401 (AISI316)	Connection type:	Wafer (Between flanges)
6	Stem packing	PTFE	Operation:	Lever
7	Handle	Stainless steel 1.4401 (AISI316)	Actuation:	quarterturn
			Tmax	120 °C

Dn	Pressure rating	Connection	L	D	L1	H	J	Weight (kg)
65	16	16	104	185	84,5	148	262	11
80	16	16	118	200	90,6	150	262	14
100	16	16	148,4	220	108	181,5	500	23