

# GATE VALVE NON-RISING STEM F5 DIN EN 1171 (DIN 3352 T2)

Материал cast iron EN-JL1040

Налягане PN-25-16

Размер DN-40-700

## DESCRIPTIONS

Gate valves are stop valves and are widely used in industry and shipbuilding.

They are mainly used in systems that transport water or other liquid fluids, including fuels and toxic products, seawater and hydraulic oils.

## MEDIA

Water, fuels, lubricating and hydraulic oils, sea water and other.

## OPTIONS

- With position indicator
- Without position indicator
- Different materials of the internal parts (trim)

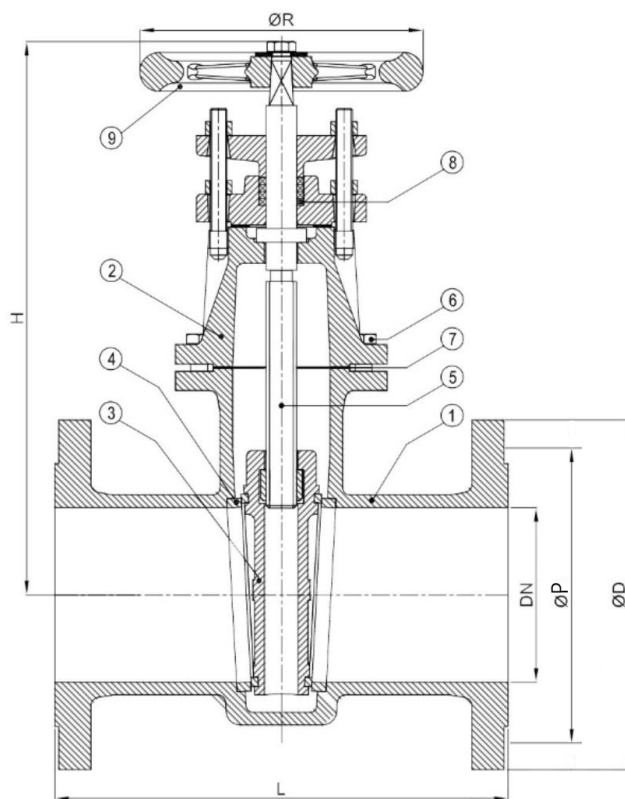

n x d (number of bolts X bolt hole diameter)

No.	Parts	Material
1	Body	Cast iron EN-JL1040 (GG25)
2	Bonnet	Cast iron EN-JL1040 (GG25)
3	Wedge	Cast iron EN-JL1040 (GG25)
4	Seat	Brass CuZn39Pb3 (CW614N)
5	Stem	Brass CuZn39Pb3 (CW614N)
6	Bolts	St. Steel AISI 304
7	Bonnet gasket	NBR bonded aramid
8	Gland packing	PTFE packing
9	Handwheel	Cast iron EN-JL1040 (GG25)

## Specifications

Building standards:	F5 DIN EN 1171 (DIN 3352 T2)
Flange standard:	EN 1092-2

# GATE VALVE NON-RISING STEM F5 DIN EN 1171 (DIN 3352 T2)

Материал cast iron EN-JL1040

Налягане PN-25-16

Размер DN-40-700

Specifications		
Face to face standard:	EN 558, series 15	
Bonnet connection:	Bolted	
Execution:	Straight	
Connection type:	Flanged	
Operation:	Handwheel	
Actuation:	Multiturn	
Bore	pressure and temperature range	Max. temperature
DN 40 thru DN 300	16 bar - 80°C	80°C (due to NBR bonnet gasket)

Dn	Pn	Flange/pn	ød			øp*			N x d			L	H	ør	Kg
			py6	py10	py16	py6	py10	py16	py6	py10	py16				
40	10	6/10/16	130	150	150	100	110	110	4x14	4x18	4x18	240	240	200	13
50	10	6/10/16	140	165	165	110	125	125	4x14	4x18	4x18	250	250	200	14
65	10	6/10/16	160	185	185	130	145	145	4x14	4x18	4x18	270	275	250	19
80	10	6/10/16	190	200	200	150	160	160	4x18	8x18	8x18	280	285	250	25
100	10	6/10/16	210	220	220	170	180	180	4x18	8x18	8x18	300	315	315	30
125	10	6/10/16	240	250	250	200	210	210	8x18	8x18	8x18	325	415	315	48
150	10	6/10/16	265	285	285	225	240	240	8x18	8x22	8x22	350	435	315	60
200	6	6/10/16	320	340	340	280	295	295	8x18	8x22	12x22	400	580	400	97
250	6	6/10/16	375	395	405	335	350	355	12x18	12x22	12x26	450	715	500	165
300	6	6/10/16	440	445	460	395	400	410	12x22	12x22	12x26	500	770	500	235
350	4	10		505			460			16x22		550	870	500	330
400	4	10		565			515			16x26		600	950	600	440
500	4	10		670			620			20x26		700	1210	800	787
600	2.5	10		780			725			20x30		800	1340	800	1060
700	2.5	10		895			840			24x30		900	1560	800	1330

Remark: Sizes in column øP, indicate bolts circle diameter.