

# GLOBE VALVE CAST STEEL STRAIGHT DIN 3202 F1, PN 40

Материал steel 1.0619; DIN GS-C25

Налягане PN 40

Размер DN 15 - 200

## DESCRIPTION

Globe valve straight type, flanged connection with shut off, screw down non return (SDNR) or regulating function. Metal sealing. Rising stem type.

## MEDIA

- Steam. Fuel oil, lubricating oil and flammable hydraulic oil. Cargo oil. Air. Non-flammable hydraulic fluid. Boiler feedwater, condensate.  
- Seawater and freshwater.

## VARIANTS

- Regulating disc.  
- Screw down non return discs - SDNR

## OPTIONS

- Spring for SDNR.

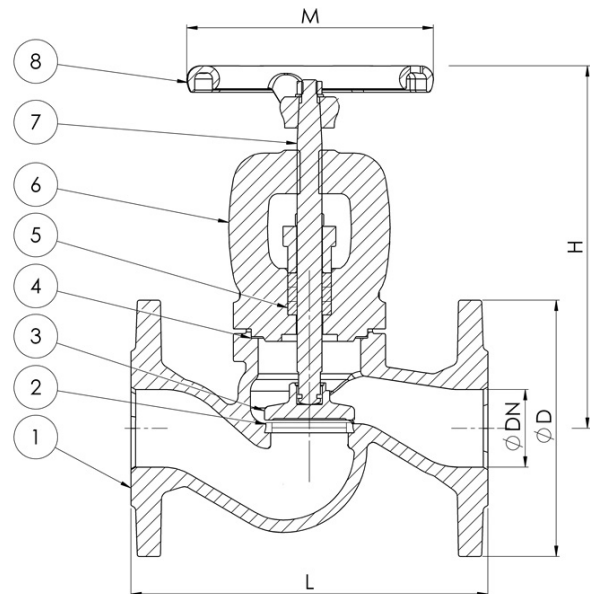

No.	Part	Material	Specifications	
			Standart:	DIN 3202 F1
1	Body	Cast Steel 1.0619 (WCB)+13Cr	Flange standard:	EN1092-2
2	Seat	Cast Steel 1.0619 (WCB)+13Cr	Face to face standard:	EN558, Series 1
3	Disc	Cast Steel 1.0482 (A105)+13Cr	Bonnet connection:	Bolted
4	Gasket	SS+Graphite	Execution:	Straight
5	Gland packing	Graphite	Connection type:	Flanged
6	Bonnet	Cast Steel 1.0619 (WCB)+13Cr	Operation:	Handwheel
7	Stem	Stainless steel EN 1.4021 2Cr13	Actuation:	Multiturn
8	Handweel	Ductile iron EN-JS1025 (GGG40.3)	Tmax	From -29 °C to 425°C

Dn	Pressure rating	Connection	L	D	P	N x d	H	M	Weight (kg)
15	40	40	130	95	65	4 x 14	165	120	4
20	40	40	150	105	75	4 x 14	165	120	4,5
25	40	40	160	115	85	4 x 14	180	140	5,6
32	40	40	180	140	100	4 x 18	180	140	7
40	40	40	200	150	110	4 x 18	215	160	11

**GLOBE VALVE CAST STEEL STRAIGHT DIN  
3202 F1, PN 40**

Материал steel 1.0619; DIN GS-C25

Налягане PN 40

Размер DN 15 - 200

<b>Dn</b>	<b>Pressure rating</b>	<b>Connection</b>	<b>L</b>	<b>D</b>	<b>P</b>	<b>N x d</b>	<b>H</b>	<b>M</b>	<b>Weight (kg)</b>
50	40	40	230	165	125	4 x 18	230	160	13
65	40	40	290	185	145	8 x 18	245	180	19
80	40	40	310	200	160	8 x 18	295	210	25
100	40	40	350	220	190	8 x 22	325	225	35
125	40	40	400	250	220	8 x 26	360	250	58
150	40	40	480	285	250	8 x 26	425	300	80
200	40	40	600	340	320	12 x 30	505	400	150