

# GLOBE VALVE TYPE 02401 UNION CONNECTION WITH STAINLES STEEL BUTT WELD ENDS

Материал bronze CC491K

Налягане PN 50

Размер DN 10 - 50

## ТЕХНИЧЕСКО ОПИСАНИЕ

Type 02401 - Globe Valve  
Cryogenic-Globe and Globe/Check Valves, PN50

Bronze body and topwork,

- live loaded gland packing
- cleaned and degreased for oxygen service
- Part No. 02401.X.0007
- Part No. 02401.X.5007 Globe/Check Valve

Completed with union type butt weld fittings for stainless steel pipes  
acc. to ISO 1127 or ASTM A312

## РАБОТЕН ФЛУИД / СРЕДА

Approved for air gases, vapours and cryogenic liquefied gases incl. LNG.

## ОПЦИИ

Available options - on request only:

- Valve with control disc (tapered design)
- Further pipe wall thicknesses

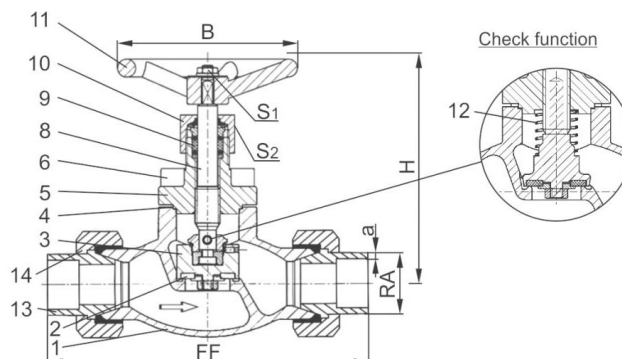

	Materials		Din en	Astm
1	Body		CC491K	B 62 UNS C83600
2	Valve seal		PTFE / Carbon filled (25%)	
3	Disc		CW614N	B 283 UNS C38500
4	Bonnet gasket		PTFE	
5	Headpiece		CC493K	B 505 UNS C93200
6	Bolts		1.4301/A2 A 194 B8	
8	Stem		1.4301	A 276 Grade 304
9	Gland packing		Graphite / PTFE	
10	Gland nut		CW614N	B 283 UNS C38500
11	Handwheel		Aluminium alloy	
12	Spring		CW452K	B 159 UNS C51900
13	Weld fitting		1.4301	A 276 Grade 304
14	Union nut		CC493K	B 505 UNS C93200
Standard marking acc. to Pressure Equipment				

# GLOBE VALVE TYPE 02401 UNION CONNECTION WITH STAINLES STEEL BUTT WELD ENDS

Материал bronze CC491K

Налягане PN 50

Размер DN 10 - 50

<b>Globe valves</b>
Type 02401 - Globe Valve
Cryogenic-Globe and Globe/Check Valves, PN50
HEROSE
Bronze body and topwork,
" live loaded" gland packing
"cleaned and degreased for oxygen service
Part No. 02401.X.0007
Part No. 02401.X.5007 Globe/Check Valve
Completed with union type butt weld fittings for stainless steel pipes acc. to ISO 1127 or ASTM A312
Available options - on request only:
? Valve with control disc (tapered design)
? Further pipe wall thicknesses

<b>Nominal size</b>	<b>Dn</b>	<b>10</b>	<b>10</b>	<b>20</b>	<b>20</b>	<b>32</b>	<b>32</b>	<b>40</b>	<b>50</b>
Dimension code	X.	1012	1017	1521	2027	2533	3242	4048	5060
Face-to-face dimension	FF	137	141	168	168	203	203	230	263
Height	H	140	140	140	140	170	170	175	200
Outside pipe-0 ISO 1127	RA	12.0	17.2	21.3	26.9	33.7	42.4	48.3	60.3
Wall thickness pipe ISO 1127	a	1.0	2.3	2.6	2.0	3.2	2.0	3.6	3.6
Outside pipe-0 ASTM A312	RA	-	17.15	21.34	26.67	33.40	42.16	48.26	60.33
Wall thickness pipe ASTM A312	a	dimensions acc. to S10 or S40							
Handwheel-0	B	100	100	100	100	125	125	125	125
Wrench size across flats	S1	7	7	7	7	7	10	10	10
Wrench size across flats	S2	30	30	30	30	36	36	36	36
Weight	ca. kg	1.2	1.2	2.4	2.4	4.0	4.0	6.3	9.5

**GLOBE VALVE TYPE 02401 UNION  
CONNECTION WITH STAINLES STEEL BUTT  
WELD ENDS**

Материал bronze CC491K

Налягане PN 50

Размер DN 10 - 50

Nominal size	Dn	10	10	20	20	32	32	40	50
Kvs-Value	m <sup>3</sup> /h	1.6	2.2	6.7	6.7	12.1	12.1	22.6	37.1
Cv-Value	gal/min	1.9	2.6	7.8	7.8	14.1	14.1	26.3	43.2
Dimensions in mm.									