

RUBBER EXPANSION JOINT / FLANGED

Материал steel / EPDM / NBR

Налягане PN 10-16

Размер DN 32 - 600

APPLICATIONS

Any kind of vibrating connection

Pressure and vacuum water system

VARIANTS AND ADVANTAGES

None

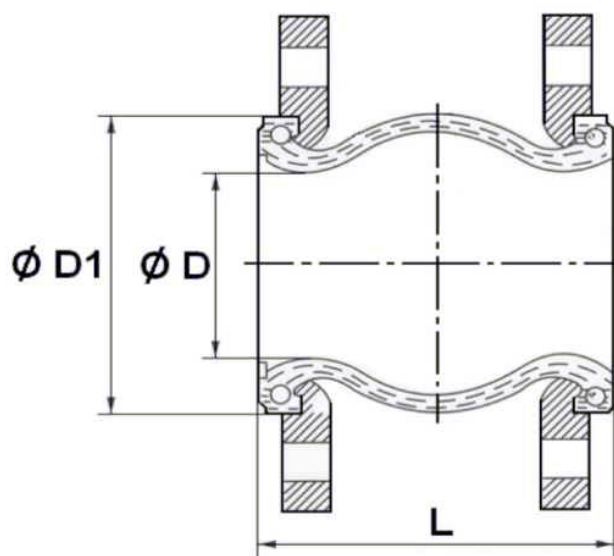

No.	Parts	Material
1	Inner Tube & Cover	EPDM / NBR
2	Reinforcement	Nylon fabric
3	Flanges	Galvanised steel
4	Brace	Hard steel

Specifications	
Standards	DIN
Rubber Expansion Joint	EPDM
HVAC & Water Duty	
DN32 - DN300:	PN 16
DN350 - DN600:	PN 10

Size	L	ϕd	$\phi d1$	Compression	Expansion	Lateral	Angular	Weight kg
DN32	95	29	69	8	4	8	15°	2,79
DN40	95	37	79	8	4	8	15°	3,59
DN50	105	47	90	8	4	8	15°	4,23
DN65	115	57	108	12	6	10	15°	4,74
DN80	130	74	124	12	10	12	15°	6,27

RUBBER EXPANSION JOINT / FLANGED

Материал steel / EPDM / NBR

Налягане PN 10-16

Размер DN 32 - 600

Size	L	ød	ød1	Compression	Expansion	Lateral	Angular	Weight kg
DN100	135	91	145	18	10	12	15°	6,47
DN125	170	119	179	18	10	12	15°	9,4
DN150	180	145	209	18	10	12	15°	12,75
DN200	205	199	261	20	14	18	15°	17,73
DN250	240	241	320	22	14	18	15°	23,27
DN300	260	294	370	24	14	18	15°	29,4
DN350	265	331	420	25	16	18	15°	41,3
DN400	265	372	473	25	16	18	15°	46,85
DN450	200	431	532	20	12	18	15°	55,18
DN500	200	486	587	20	12	18	15°	65
DN600	250	591	685	20	12	18	15°	74,5