

RUBBER EXPANSION JOINT / UNION CONNECTIONS

Материал steel / EPDM / NBR

Налягане PN 10

Размер DN20-8034-3inch

APPLICATIONS

Any kind of vibrating connection

Pressure and vacuum water system

VARIANTS AND ADVANTAGES

None

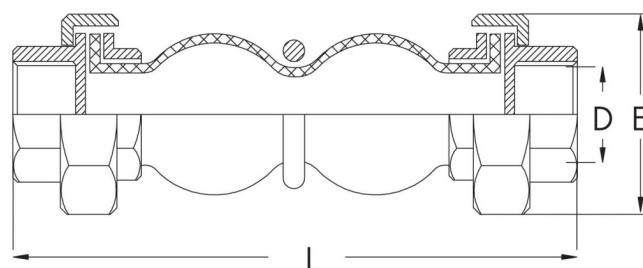

No.	Parts	Material
1	Bellows inside wall material	EPDM
2	Inlay material	PA (Nylon)
3	Bellows outside wall material	EPDM
4	Material of connection	Steel

Specifications	
Standards:	DIN
Threaded connection:	Female thread BSPP
Maximum operating pressure at 20 °C:	10 bar
Neutral length:	200 mm
Tube diameter range:	4,0 - 14,0 mm
Movement sensing, axial + :	6 mm
Movement sensing, axial - :	22 mm
Movement sensing, lateral +/- :	22 mm

Dn	D	L	E	Maximal movement records				Vacuum	Weight
				Compression	Expansion	Lateral	Angular		
[mm]	Inch ["]	[mm]	[mm]					[bar]	[kg]
20	3/4"	200	53,9	22	6	22	30	0,5	0,7
25	1"	200	66,1	22	6	22	30	0,5	1,2
32	1 1/4"	200	72,4	22	6	22	30	0,5	1,6
40	1 1/2"	200	89,3	22	6	22	30	0,5	2,0
50	2"	200	101,6	22	6	22	30	0,5	2,7
65	2 1/2"	240	124,4	22	6	22	30	0,5	4,5
80	3"	240	138,6	22	6	22	30	0,5	5,0