

# STAINLESS STEEL CHECK SCREWED DIN PN 40

Материал stainless steel 1.4408; AISI 316  
 Налягане PN 40  
 Размер G 1/2" - 3"

## DESCRIPTION

Swing check valve with metal/metal disc sealing, flanged connection and screwed cover.

## MEDIA

- Fuel oil, lubricating oil and flammable hydraulic oil. Boiler feedwater, condensate. Seawater and freshwater.

## VARIANTS

Other materials on request

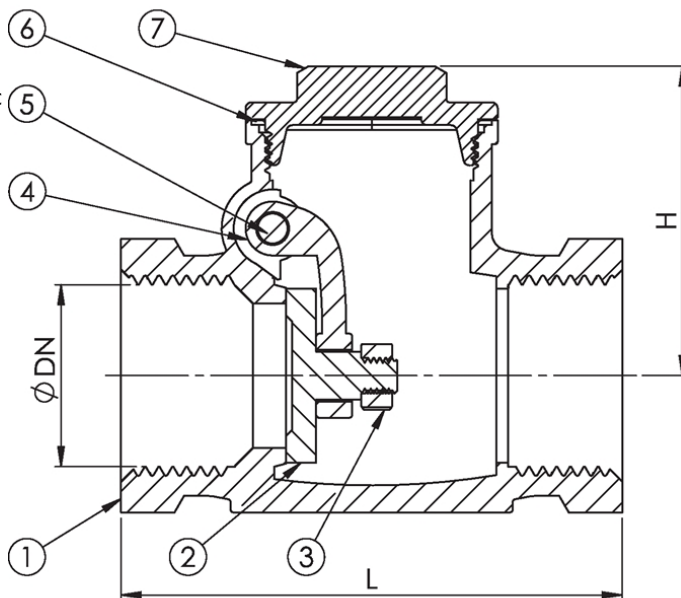

| No. | Part     | Material                          | Specifications     |                  |
|-----|----------|-----------------------------------|--------------------|------------------|
| 1   | Body     | Stainless steel 1.4301 (AISI304)  | Standart:          | DIN              |
| 2   | Disc     | Stainless steel 1.4301 (AISI304)  | Screw type         | NPT              |
| 3   | Disc nut | A2                                | Bonnet connection: | Screwed          |
| 4   | Rod      | Stainless steel 1.4401 (AISI 316) | Execution:         | Straight         |
| 5   | Pin      | Stainless steel 1.4401 (AISI 316) | Connection type:   | Screw ends       |
| 6   | Gasket   | PTFE                              | Operation:         | Non-return valve |
| 7   | Cap      | Stainless steel 1.4301 (AISI304)  | Actuation:         | Self Return      |
|     |          |                                   | Tmax               | 200 °C           |

| Dn | Pressure rating | Connection | L   | H  | Weight (kg) |
|----|-----------------|------------|-----|----|-------------|
| 15 | 16              | G 1/2"     | 60  | 42 | 0,3         |
| 20 | 16              | G 3/4"     | 78  | 46 | 0,5         |
| 25 | 16              | G 1"       | 84  | 49 | 0,7         |
| 32 | 16              | G 1 1/4"   | 94  | 54 | 0,9         |
| 40 | 16              | G 1 1/2"   | 104 | 59 | 1,2         |

# STAINLESS STEEL CHECK SCREWED DIN PN 40

Материал stainless steel 1.4408; AISI 316

Налягане PN 40

Размер G 1/2" - 3"

| Dn | Pressure rating | Connection | L   | H   | Weight (kg) |
|----|-----------------|------------|-----|-----|-------------|
| 50 | 16              | G 2"       | 122 | 67  | 1,8         |
| 65 | 16              | G 2 1/2"   | 153 | 105 | 3,5         |
| 80 | 16              | G 3"       | 175 | 125 | 5           |