

STEEL FORGED THREADED TEE NPT ANSI B16.11

Материал steel A105
Налягане 3000 LBS
Размер G1/2" - G2"

APPLICATIONS

A tee is a connecting piece that enables an existing connection to branch-off. It connects three pipes of the same or different diameters. We differentiate between equal and reduced tees.

VARIANTS

Other materials: Ferritic and Austenitic steels

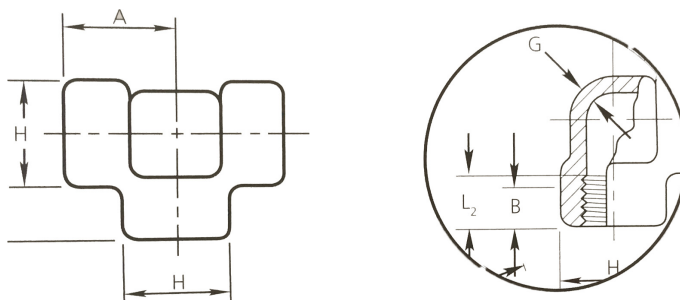

No.	Part	Material
1	Tee	Carbon steel A105

Specifications	
Standart:	ANSI B16.11
Pressure Rating:	3000 LBS
Thread standard:	NPT

Dn	Nom.dia.	A mm	H mm	Min. length of thread		Kg
				B mm	L2 mm	
8	1/4"	25	25	8,1	10,2	0,17
10	3/8"	28	33	9,1	10,4	0,32
15	1/2"	33	38	10,9	13,6	0,52
20	3/4"	38	46	12,7	13,9	0,73
25	1"	44	56	14,7	17,3	1,26
32	1 1/4"	51	62	17,0	18,0	1,64
42	1 1/2"	60	75	17,8	18,4	2,81
50	2"	64	84	19,0	19,2	4,00