

THERMODYNAMIC STEAM TRAP SCREW ENDS / FLANGED ADCA DT 42/2

Материал cast steel 1.0460

Налягане PN 63

Размер 1/2" - 1"

TECHNICAL DESCRIPTION

The ADCA DT 42/2 Thermodynamic steam traps are compact, lightweight and easy to install and excellent for installation in high-pressure systems. The steam traps of this type have only one movable element and are used in a wide range of working pressures without additional adjustment. Two different connection available - threaded or flanged.

OPERATION

Discharge with interruption. Workign with superheated steam. The seat and valve have an option to replace them without removing the condensate separator. It is not affected by hydraulic shocks and vibrations in the system. Built-in filter is easy to service.

OPTIONS

- Anti - freesing device.

APPLICATION

- Steam saturated and superheated.

INSTALLATION

- Horizontal installation is recommended.

RESTRICTIONS

- Minimum working pressure up to 0.25 bar
- Maximum working pressure up to 80% Bar

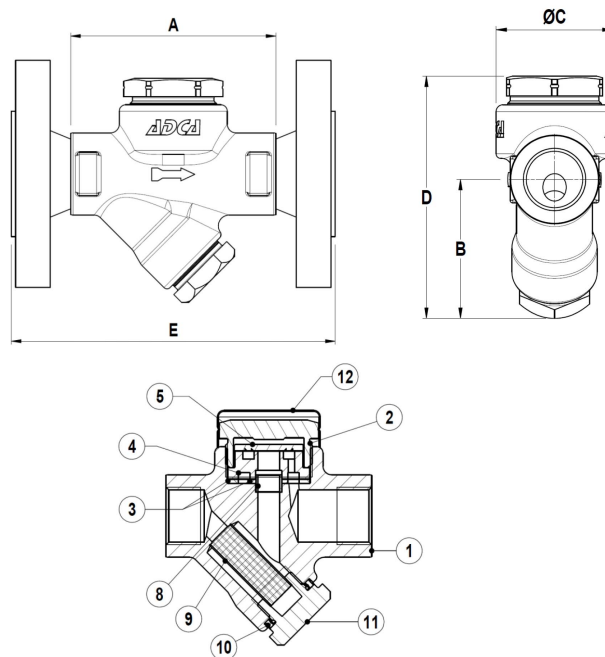

No.	Part	Material
1	Body	Cast Steel 1.0619
2	Internals	CF8M / 1.4408

Specifications	
Building standards:	DIN
Connection:	Threaded BSP
Bonnet connection:	Screw bonnet

THERMODYNAMIC STEAM TRAP SCREW ENDS / FLANGED ADCA DT 42/2

Материал cast steel 1.0460

Налягане PN 63

Размер 1/2" - 1"

Specifications	
Execution:	Straight
Operation:	Automatic
Air release:	With automatic air release
Mounting:	Preffered horisontal

Max. working pressure (bar) at °c		
PMO - maximum operating pressure	46	[bar]
Minimum operating pressure	0.3	[bar]
TMO - maximum operating temperature	400*/425	[°C]
Maximum back pressure	inlet pressure 0.8	Bar
Remark: *with flange conection		

G	L	H	H1	Weight (kg)
1/2"	80	120	62	1.2
3/4"	80	120	62	1.2
1"	88	125	62	1.4