

WELD NECK FLANGE TYPE 11/B1 EN1092-1 PN 25

Материал steel EN P250GH
 Налягане PN 25
 Размер DN 10 - 1000

TECHNICAL DESCRIPTION

Weld neck flanges according to EN1092-1 / type 11 / B1 are one of the most common used pipe connection elements and are widely used in building of steel pipelines and pipe spools for industry and repairs of many branches.

Our stock availability consists of steel flanges according to EN1092-1 type 01 / with sealing surface B1 and sizes up to DN2000. We have all necessary machine equipment, that allows us to machine flanges with different profiles and sealing surfaces as follows.

- type of sealing surface A, B2, C, D, E, F
- non-standard sealing surfaces as per clients specification
- machining of profile channels for metal sealing rings type RTJ
- custom machined flanges made by clients specification.

MATERIALS KEPTED ON STOCK:

- Carbon steel

P250GH (1.0460) / EN 10222-2

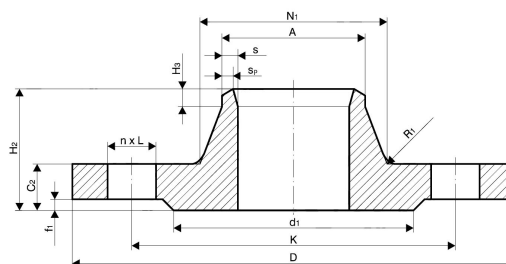

No.	Parts	Materials	Standart
1	FLANGE 11/B1 EN1092-1 PN 25	carbon steel P250GH / (1.0460)	EN 10222-2
	other carbon steel materials on request		
		P280GH / 1.0426	EN 10222-2
		16Mo3; 15Mo3 / 1.5415	EN 10222-2
	other stainless steel materials on request		
		AISI 304L (X2CrNiMo17-12-2) / 1.4404	EN 10222-5
		AISI 316L (X2CrNiMo17-12-2) / 1.4404	EN 10222-5
		AISI 321 (X6CrNiTi18-10) / 1.4541	EN 10222-5
		AISI 316Ti (X6CrNiMoTi17-12-2) / 1.4571	EN 10222-5

Specifications	
Standart:	EN1092-1 11/B1
Pressure Rating:	PN25

Dn	Pipe o.d.	Flange type 11/b1 en1092-1 pn25	Screws
----	-----------	---------------------------------	--------

WELD NECK FLANGE TYPE 11/B1 EN1092-1 PN 25

Материал steel EN P250GH

Налягане PN 25

Размер DN 10 - 1000

Dn	Pipe o.d.	Flange type 11/b1 en1092-1 pn25												Screws		
		D	K	L	H2	C2	N1	H3	R	s	Sp	d1	f1	Weight kg	n	Size
10	13,5*	90	60	14	35	16	25	6	4	2	2	40	2	0,72	4	M12
	17,2						28							0,68		
15	20,0*	95	65	14	38	16	30	6	4	2	2	45	2	0,82	4	M12
	21,3						32							0,77		
20	25,0*	105	75	14	40	18	38	6	4	2,3	2,3	58	2	1,15	4	M12
	21,3						40							1,09		
25	30,0*	115	85	14	40	18	42	6	4	2,6	2,6	68	2	1,60	4	M12
	33,7						46							1,30		
32	38,0*	140	100	18	42	18	52	6	6	2,6	2,6	78	2	1,99	4	M16
	42,4						56							1,91		
40	44,5*	150	110	18	45	18	60	7	6	2,6	2,6	88	3	2,33	4	M16
	48,3						64							2,15		
50	57,0*	165	125	18	48	20	72	8	6	2,9	2,9	102	3	2,90	4	M16
	60,3						75							2,85		
65	76,1	185	145	18	52	22	90	10	6	2,9	2,9	122	3	3,68	8	M16
80	88,9	200	160	18	58	24	105	12	8	3,2	3,2	138	3	4,78	8	M16
100	108,0*	235	190	22	65	24	128	12	8	3,6	3,6	162	3	4,56	8	M20
	114,3						134							6,46		
125	133,0*	270	220	26	68	26	155	12	8	4	4	188	3	9,40	8	M24
	139,7						162							8,86		
150	159,0*	300	250	26	75	28	182	12	10	4,5	4,5	218	3	12,10	8	M24
	168,3						192							11,70		
200	219,1	360	310	26	80	30	244	16	10	6,3	6,3	278	3	17,10	12	M24
250	273,0	425	370	30	88	32	298	18	12	7,1	7,1	335	3	24,30	12	M27
300	323,9	485	430	30	92	34	352	18	12	8	8	395	4	31,80	16	M27
350	355,6	555	490	33	100	38	398	20	12	8	8	450	4	48,80	16	M30
400	406,4	620	550	36	110	40	452	20	12	8,8	8,8	505	4	63,30	16	M33
450	457,0	670	600	36	110	46	500	20	12	8,8	8,8	555	4	76,00	20	M33
500	508,0	730	660	36	125	48	558	20	12	10	10	615	4	97,00	20	M33
600	610,0	845	770	39	125	48	660	20	12	12,5	11	720	5	121,00	20	M36
700	711,0	960	875	42	129	50	760	20	12	14,2	12,5	820	5	155,00	24	M39
800	813,0	1085	990	48	138	53	864	22	12	16	14,2	930	5	205,00	24	M45

**WELD NECK FLANGE TYPE 11/B1 EN1092-1
PN 25**

Материал steel EN P250GH

Налягане PN 25

Размер DN 10 - 1000

Dn	Pipe o.d.	Flange type 11/b1 en1092-1 pn25													Screws	
		1185	1090	48	148	57	968	24	12	17,5	16	1030	5	249,00	28	M45
900	914,0															
1000	1016,0	1320	1210	56	160	63	1070	24	16	20	17,5	1140	5	338,00	28	M52

*) Pipe diameters not provided for in standard EN 1092-1: 2013 - can be made for special customer order."